

Factory Profile

OF

R. Tex Fashion Ltd.

226, North Badda , Satarkul Road,
Dhaka-1212, Bangladesh.

TEL : +88-02-55056946

Mobile : +88 02 01711007532

www.rtexfashionltd.com

Index

- ⦿ **Contents**
- ⦿ Introduction about R. Tex Fashion Ltd.
- ⦿ Facilities
- ⦿ Address
- ⦿ Factory Details
- ⦿ Production Capacity
- ⦿ Product
- ⦿ Customer
- ⦿ Sewing Floor Lay out
- ⦿ Finishing Floor Lay out

- ◎ Store Department
- ◎ List of Machineries
- ◎ Sample Section
- ◎ Cutting Section
- ◎ Sewing Section
- ◎ Quality Assurance
- ◎ Sewing Quality Control
- ◎ Finishing Department
- ◎ Management

Introduction

- Our last year turnover was \$ 3 million and we are expecting to achieve \$ 3.5 million 2015.
- There are strong merchandising team and they can handle
- Developments, samples, sourcing and supply chain individually.
- We are sourcing fabric from china, and locally .
- We work on all kind of Knit Item .
- We are strong in all Kind of Jacket, Hoody Jacket, Polo Shirt, T-Shirt, Trouser ,Long Pant, Short Pant,
- Our monthly productivity is **150,000** pcs.

- With latest & modern equipment.
- Open space for every worker as per compliance law.
- Modern firefighting equipment and easy evacuation plan for emergency exit as per labor law policy .
- Group insurance for all staffs and workers as per labor law policy act 2006.
- Medical room with specialized doctor & nurses with emergency supporting equipment with medicines as per labor law policy.

- Clean and hygienic environment everywhere.
- Day-care center for babies of female workers as per labor law policy, including playing place with separate room for Brest feeding .
- Dining hall facility for all factory workers & staff as per labor law policy.
- Exhaust fans fixed to the wall for breathing environment and to make the floor cool.

- ⦿ generator facility. Capacity 220 KWE, made in England
- ⦿ All over the factory well designed layout and fire evacuation plan for easy exit during emergency time.
- ⦿ Separate Prayer rooms for male & female workers.
- ⦿ R. Tex Fashion Ltd is fully equipped with public announcing system (PA system)
- ⦿ For emergency exit each floor is having 2 numbers of staircases.

Address

Factory

R. Tex Fashion Limited
226, North Badda, Satarkul Road,
Dhaka-1212, Bangladesh .

Contact Persons:

Md. Ripon Bhuiya
Managing Director
Contact : +8801711007532
E-mail : ripon@rtexfashionltd.com
rtexfashion@yahoo.com

Md. Shah Alam
Chairman
Contact : +8801713031873
E-mail : s.alam@rtexfashionltd.com

Bank Details

NRBC Commercial Bank Limited.
Gulshan Branch
52 Gulshan Avenue .
Dhaka-1212, Bangladesh
SWIFT : NRBBDDHGUL

Md. Polash Sarkar
Merchandising Manager
Contact : +8801670068910
E-mail : polash@rtexfashionltd.com

Saimon Ali
Asst. Merchandising Manager
Contact: 01688196519
E-mail: saimon@rtexfashionltd.com

Factory Details

- ◎ **Work Force:**
- ◎ At this moment there are 450 workers and staff working together.
- ◎ **Factory Space:**
- ◎ R.Tex Fashion Ltd, comprising of Six Storied Building.
- ◎ Building. Total work Space : Total 3800 Sft. Each floor 22800 sft.

Production Capacity:

- ⦿ At this moment our production capacity is 12500 dz per month (150,000 pcs)
- ⦿ Per month, consideration of 26 working days in a month.
- ⦿ Total 6 lines & each lines of 32 machines lay out.

Our Products

- We can manufacture all kind of
- Knit Garments
- such as..
 - . Jacket
 - . Hoody Jacket
 - . Sweat Shirt
 - . Polo Shirt
 - . T-Shirt
 - . Fancy Ladies Tops
 - . Knited Trouser
 - . Sports wear



Our Customers

- ◎ **ATLAS** - **Germany/France**
- ◎ **DECIMAS** - **Spain**
- ◎ **MOUNTAIN WEARHOUSE** - **UK./Canada**
- ◎ **TRESPASS** - **UK./Canada**
- ◎ **PIAZAITALIA** - **ITALI**
- ◎ **TEXTILES SANMATEU** - **Spain**
- ◎ **ANERKJENDT** - **UK**

Sewing Floor Layout

2nd Floor
Sewing section-1

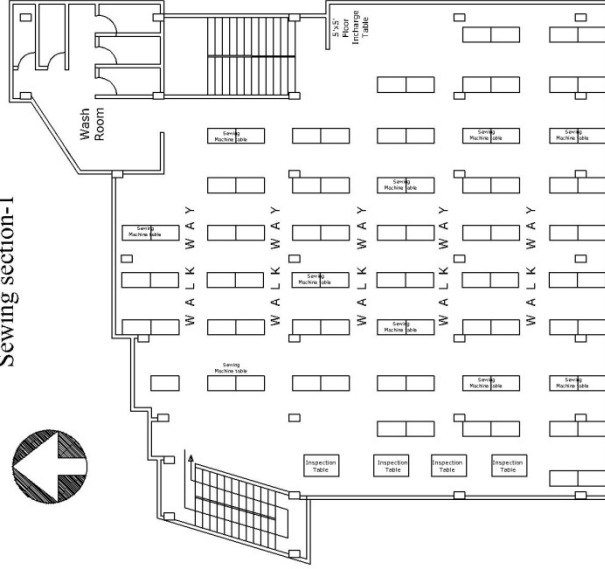

3rd Floor
Sewing section-2

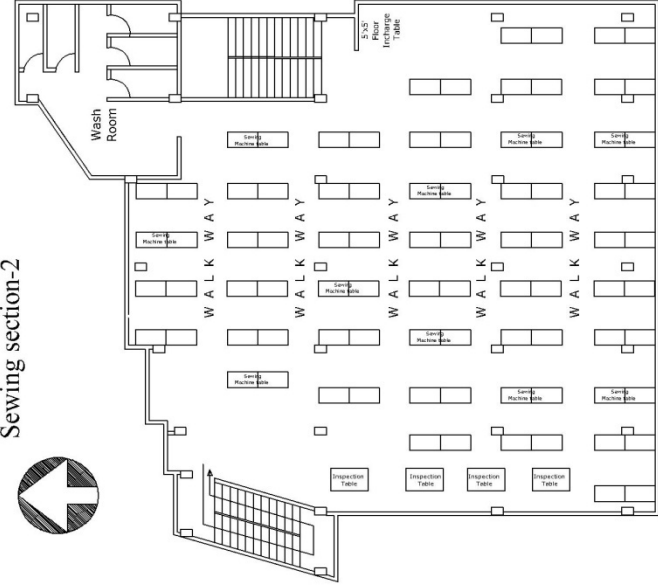

Cutting Floor Layout

4th Floor

Cutting Section

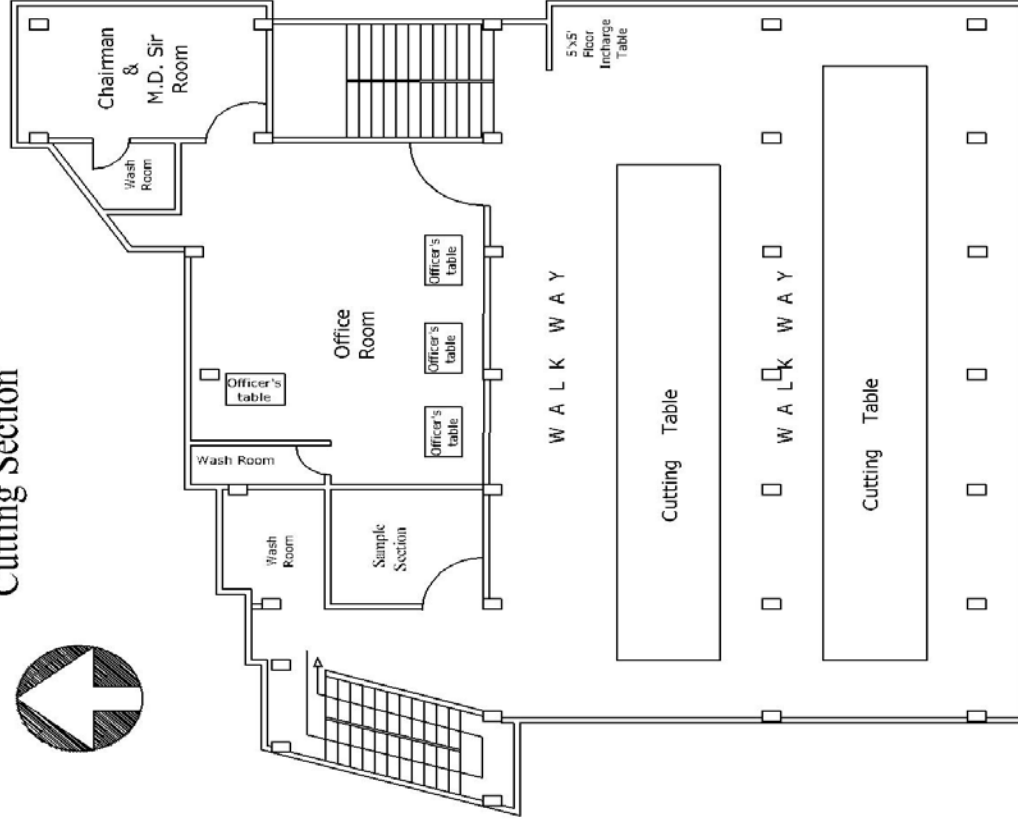

Storing Facility:

- For any new order, all the raw materials (Shell fabric, pocketing fabric, fusing, trims and accessories, etc.) are received by the store department.
- Main functions of store department
- Fabric inspection 4 point system
- Accessories inspection AQL 2.5

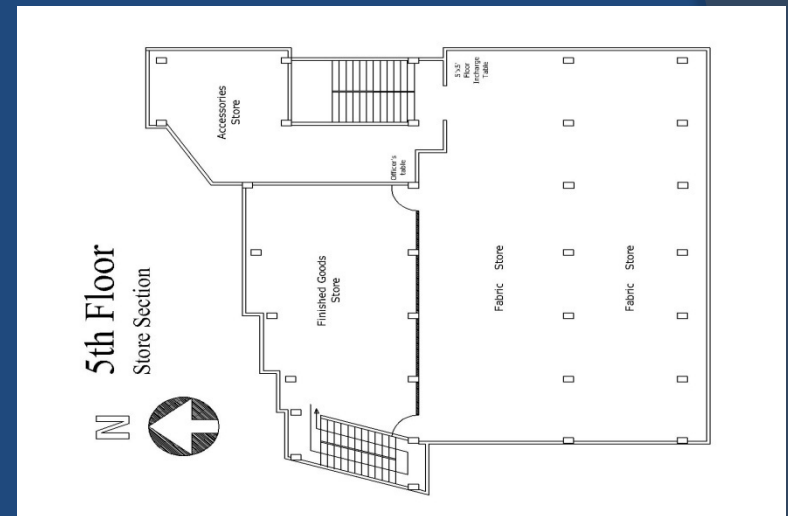

- To maintain an inventory of all the material received.
- To issue material to the various departments as per their requirement.
- The material which are maintained by the stores department Fabric ,Trims, Machinery and equipments.

List of Machineries

Machine Name	Nos.
OVER LOCK MACHINE	56 Set.
FLAT LOCK FLAT BED	04 Set.
FLAT LOCK CYLINDER BED	23 Set.
PLAIN MACHINE	95 Set.
BACK TAP MACHINE	01 Set.
THRED TREMAR MACHINE	06 Set.
BUTTON HOLE MACHINE	03 Set.
BUTTON STITCH MACHINE	04 Set.
RIB CUTTING MACHINE	02 Set.
RING SNAP BATTON MACHINE	06 Set.
KANSI SPISAL PMD	02 Set.
BARTACK MACHINE	04 Set.

FABRIC CUTTING MACHINE	04 Set.
G.S.M. WIGHT MACHINE	01 Set.
G.S.M CUTTER MACHINE	01 Set.
FABRIC WIGHT MACHINE	02 Set.
STEAM GAS BOILER+12 IRON	01 Set.
VACUUMING IRON TABLE	12 Set.
THREAD SUCKING MACHING	01 Set.
FABRIC INSPECTION TABLE	01 Set.
DIESEL GENERATOR 220 KVA	01 Set.
ELICTRICK BOILER +6 IRON	01 Set.

Sample Section

Sampling is the process by which a small number of garments are made so as to match the buyer requirement and to get approval from the buyer



Main functions of sampling department.

To develop samples as per the buyers requirements.

To develop a fabric consumption report for each order.

Various samples which are being developed at different stages are being mentioned below:-

- a) Proto Sample
- b) Fit Sample
- c) Sales Sample
- d) Pre Production Sample
- e) Size Set Sample



Cutting Section

Cutting is one of the important department of the manufacturing unit. The first stage in the manufacture of the garments is the cutting of the materials into the necessary patterns shapes.



The pattern shapes for these garments maybe drawn on a paper marker placed on top of the lay, or information as to their shape and position maybe held within a computer, to be plotted similarly on the paper marker or used to drive an automatic cutter.

Sewing Department

Sewing department is responsible for stitching the garment as per the sample and Tec pack provided by the sampling department.

Assembly line system is followed here with a combination of modular system. In this system there are different line/teams which individually do the production. The team works on few garments at a time instead of a bundle of garments and the operators are continuously motivated to work as a team and try to achieve the target production.



Quality Assurance

Piece Goods Quality Control

After 100% inventory, all the trims item with all accessories has to inspected as per AQL standard 1.5 . Failed items has to be keep on hold and it has to inform to merchandiser immediately and reject specimen has to be sent to merchandiser along with inspection report. Based on merchandising approval it has to be done 100% inspection before issuing trims & other accessories to production. Quantity less than 10,000 should be checked 100% .



Sewing Quality Control Policy

- If defect is found keep line supervisor informed and operator to carry Yellow tag
- If the defect was not corrected (repeated) in the next hour. Random check of cut panels at input section.
- 100% inspection at assigned initial key operation by line Q/C.
- operator will be marked with Red tag until the defect is corrected. Consult QC whether to stop the operation.
- QC is required to check all operators within first hour of work to ensure standards
- Random inspection at key operations to be carry out by QC for 10 garments (or pieces) and allow only one defect with own judgment or reject the whole bundle and hand over to line supervisor. All defective garments to be marked. Recheck the operation within next hour or at intervals of 10 min, 20 min, etc depending on the gravity of fault .

Finishing Department

Finishing department is responsible for incorporating the buyer's specified finishes to the stitched garments and packing those garments as per the specified packing details, specified by buyer. Each line takes input from the corresponding sewing line and prepares the garments for prepare The packing .



Management



Md. Ripon Bhuiya

Managing Director

Cell : +8801711007532

Md. Shah Alam

Chairman

Cell :+8801713031873

Md. Polash Sarkar

Merchandiser Manager

Cell :+8801670068910

Md. Robal

Production Manager

Cell : +8801881053981

Md. Norul Alam

Asst.Production Manager

Cell : +8801707713489

Laws & Securities

- Modern firefighting equipment and easy evacuation plan for emergency exit as per labour law policy.



Conclusion

Our conclusion is mainly to give end customer good quality finished products & keep delivery on time. Therefore, we have professional expert to manage our entire factory smoothly. We have recruited the most experience staff and Skilled workers to ensure our commitment of high quality garment's to our customers.

Moto of R. Tex Fashion Ltd. :

Our business policy is “Fashion and Quality garments at the best price within a committed time frame” We don't compromise with any of them. The good prices are ensured due to good sources, efficient production planning and a good Quality Assurance system. We commit to supply top quality product at the best possible price.

Lead Time: Average Lead time of 90 to 120 days.

Thanking You